

Project
Type
Date
Cat #

Application Features

Premium-grade, surface-mounted wrap-around luminaire with low-brightness linear sides. For use with indoor applications where high-efficiency, high-performance and ease of installation are required.



Specifications

Optical System

Standard diffuser is clear acrylic with prismatic bottom and ribbed linear sides designed for even and low-glare illumination. Optional reflectors are available in specular aluminum with a minimum reflectance of 95%.

Mounting

Mounts over electrical junction box. Mounting holes are provided within offset to prevent distortion of housing when tightening mounting fasteners. Offset mounting pads which keep luminaire level and slightly off of the mounting surface are formed within the housing.

Construction

Die-formed, code gauge pre-painted, high-reflectance white steel housing. Ballast cover snaps into place eliminating the need for tools when accessing the ballast. Flattened knockouts are provided on ends for conduit attachment. Diffuser hinges from either side in a lift and shift manner and is self-centered for easy re-lamping and re-ballasting. This luminaire is suitable for row-mounting.

Finish

Pre-painted, high-reflectance white housing.

Electrical

Rotary lampholders ensure positive lamp retention. Sufficient knockouts are provided for connections and through wiring.

Approvals

Approved to CSA and UL standards.

Features

- Available with only 1 lamp (T5 and T8 configurations)
- Available in 48 and 96 inch lengths
- Clear, acrylic diffuser with prismatic bottom and ribbed linear sides
- Diffuser hinges from either side and is self-centered for easy re-lamping and re-ballasting
- Continuous row-mounting capability

Options & Adders

- Enhanced specular aluminum reflector with a minimum reflectance of 95%
- Dimmable and Emergency ballast
- Single-piece 8 foot diffuser (special order)
- Joiner band
- Stem and canopy sets

Applications

- Classrooms
- Corridors
- Kitchens
- Stairwells
- Utility Areas
- Office Areas

Dimensions

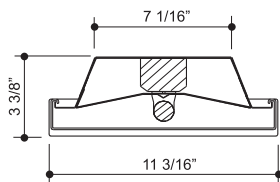

Cross Section 1 LAMP

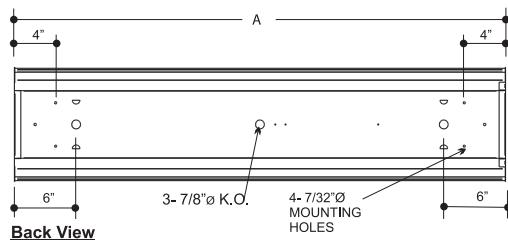

Back View

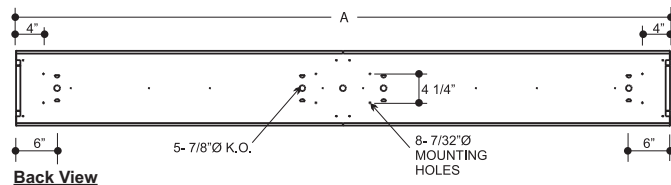

Back View

MODEL LENGTH	
1 LAMP	A (in)
148	48
148/2	96

