



INTRODUCING: LCOMN LED Commercial Type N



Commercial-Grade LED Strip Luminaire

The LCOMN is a Commercial-Grade Luminaire featuring a shallow design and a narrow profile. The LCOMN's extruded micro-grooved lens is extremely durable and designed for easy, tool-less access. This luminaire is ideal for coves, cold storage, retail shelving, industrial racks, utility areas, and more.

Specifications:

- Extruded Micro-Grooved Round Polycarbonate Lens
- Surface or suspended mounting
- 80+ CRI
- CSA and UL listed
- DLC Qualified

Features:

- 120+ lm/W
- Shadow-less continuous light (4000K)
- Narrow design
- Continuous raceway and row-mounting capability
- Standard low voltage dimming (0-10v)
- 24", 48", 96" configurations

Specifications and dimensions subject to change without notice. Consult your representative or www.viscor.com for additional information. Not all configurations may be DLC qualified. Visit www.designlights.org/QPL for qualified configurations.

Dimensions

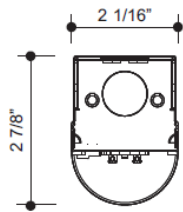

Standard

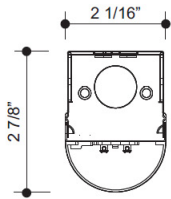
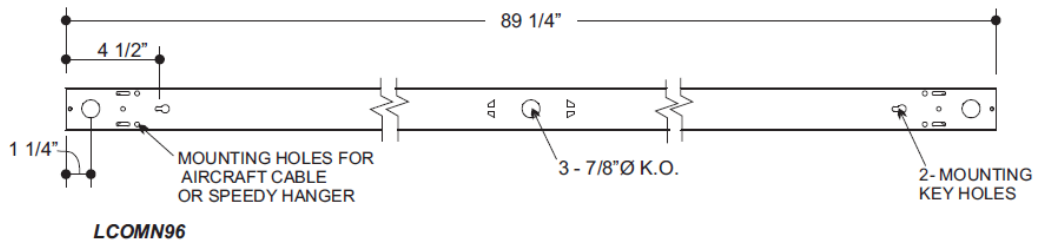
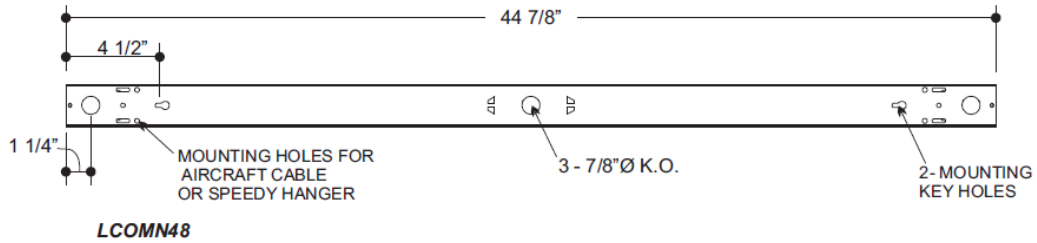
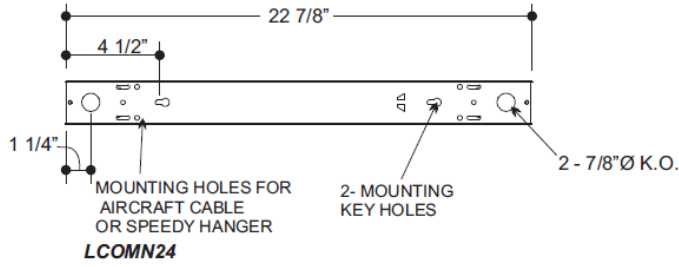

Standard

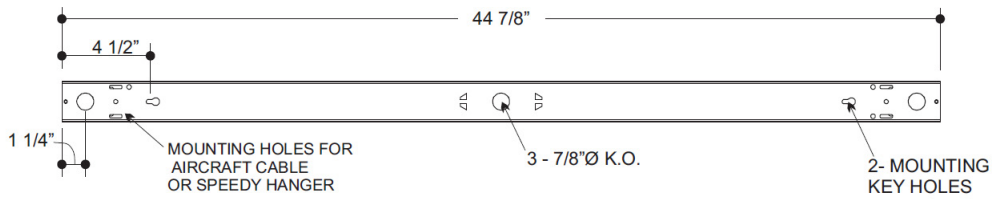

Specifications and dimensions subject to change without notice. Consult your representative or www.viscor.com for additional information. Not all configurations may be DLC qualified. Visit www.designlights.org/QPL for qualified configurations.