

SURFACE MOUNT KIT FOR 4"AND 6" DEPTHS

Title: **KIT00316, KIT00326, KIT00327, KIT00373, KIT00374, KIT00375**

ERP# IIS00376 Date: 06-12-2023 Rev: 1.0

WARNINGS

Electric shock:

- Disconnect or turn off power before installing or servicing luminaire.
- All electrical wiring to be completed by a qualified licensed electrician in accordance with local and National/Canadian Electrical Code.
- Ensure supply voltage corresponds with the correct ballast/driver voltage.
- Avoid exposing wiring to metal edges and sharp objects.
- Ensure that the luminaire is properly grounded to prevent electric hazards.

Fire:

- Keep flammable and combustible materials away from the light source and/or lens.
- Use correctly rated supply conductors as indicated by product labeling.

Burn:

- Allow luminaire to cool before handling luminaire.

Personal Injury:

- Wear safety glasses and gloves when handling the luminaire to avoid physical injury.
- Avoid direct eye contact with light source.
- Always support the weight of the luminaire.

Compatible with series model;
LRT's & OXR/BVL

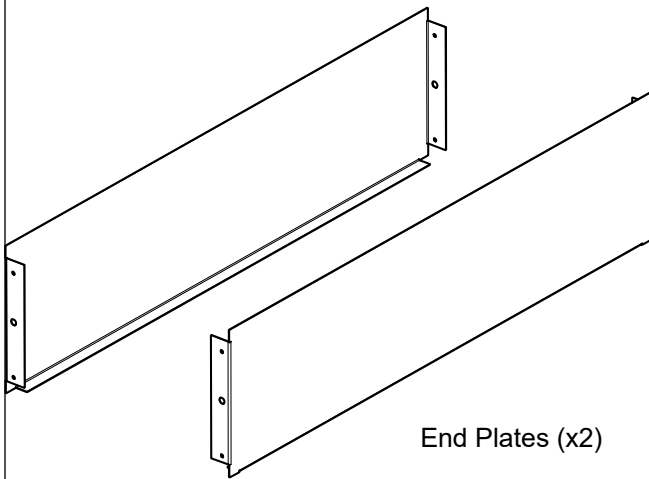

End Plates (x2)

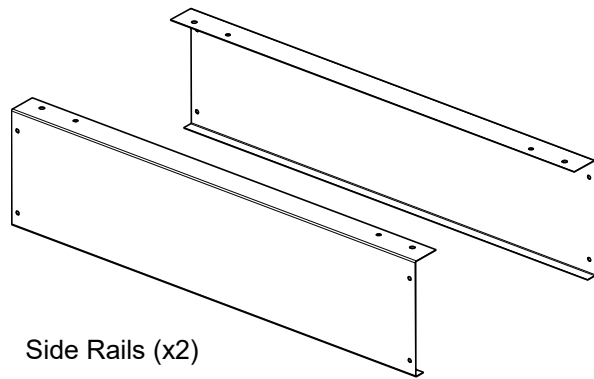

Side Rails (x2)

Parts Bag:



8 x 1/4" Length
Screw (x8)

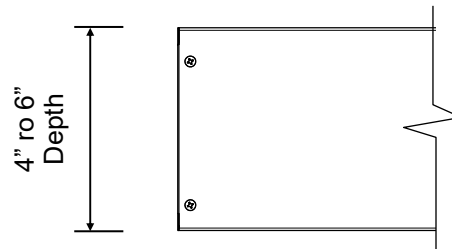

4" DEPTH

KIT00316 - 2X4
KIT00326 - 1X4
KIT00327 - 2X2

6" DEPTH

KIT00373 - 1X4
KIT00374 - 2X2
KIT00375 - 2X4

**SURFACE MOUNT KIT FOR
4" AND 6" DEPTHS**

Title: **KIT00316, KIT00326, KIT00327, KIT00373, KIT00374, KIT00375**

ERP# IIS00376 Date: 06-12-2023 Rev: 1.0

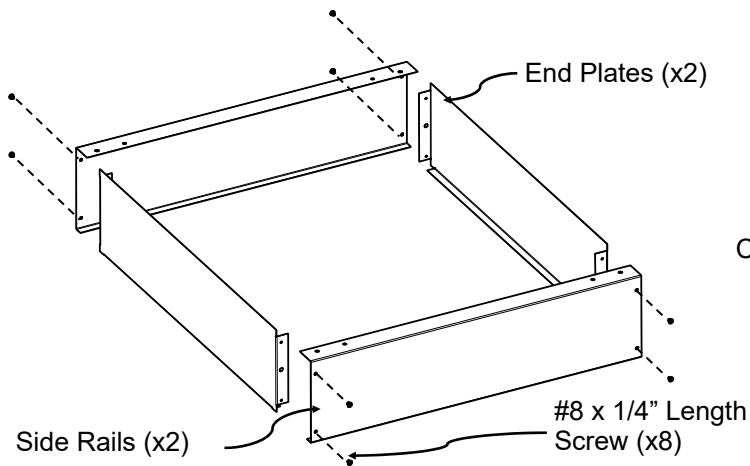

Step 1. Install the end plates to the side rails together and fasten with screws provided (# 8 x 1/4" Length).

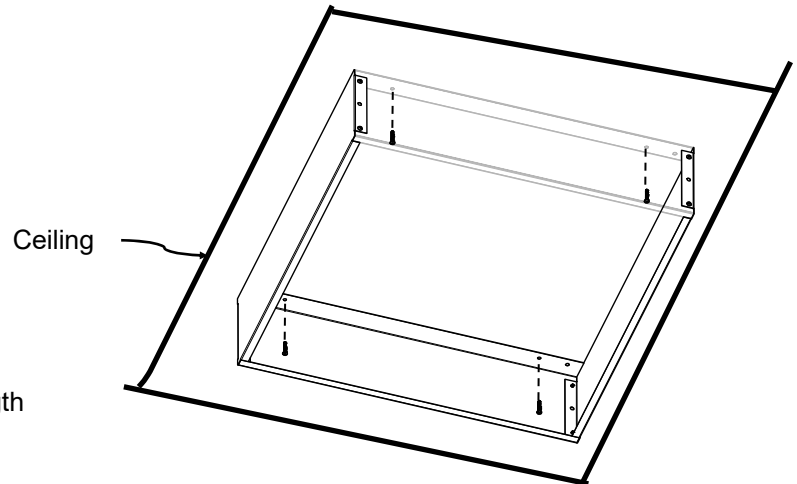

Step 2. Install the four-sided frame to ceiling (hardware by others) Note: Recommended for suitable fasteners rated for fixture weight up to maximum of 40lbs (18kg)

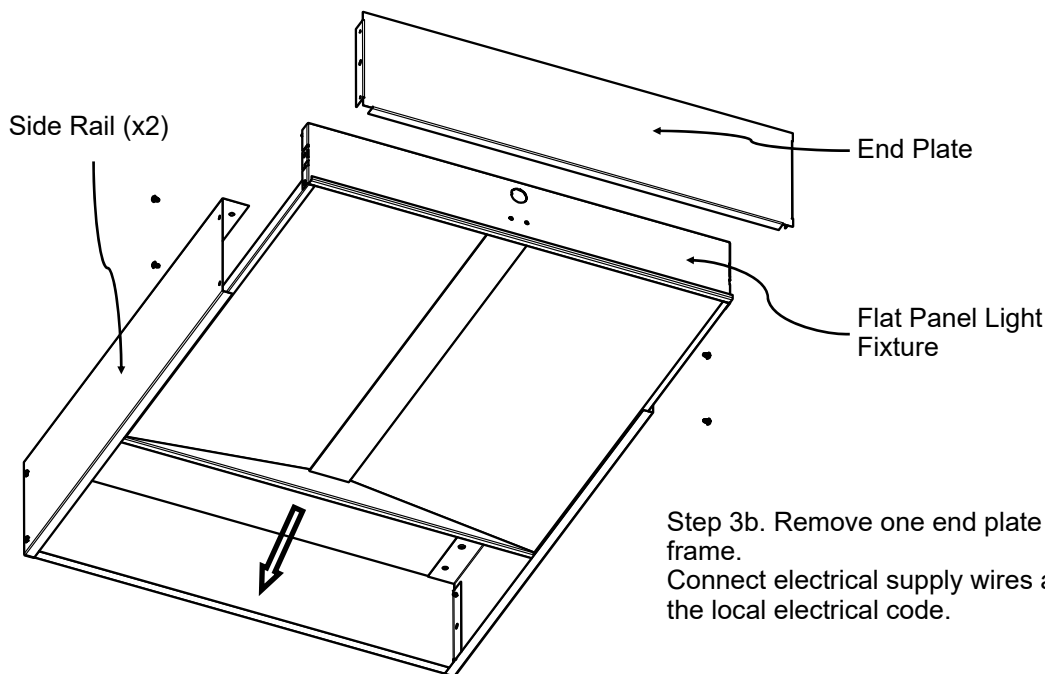

Step 3b. Remove one end plate and slide the Luminaire into frame. Connect electrical supply wires and ground as required by the local electrical code.

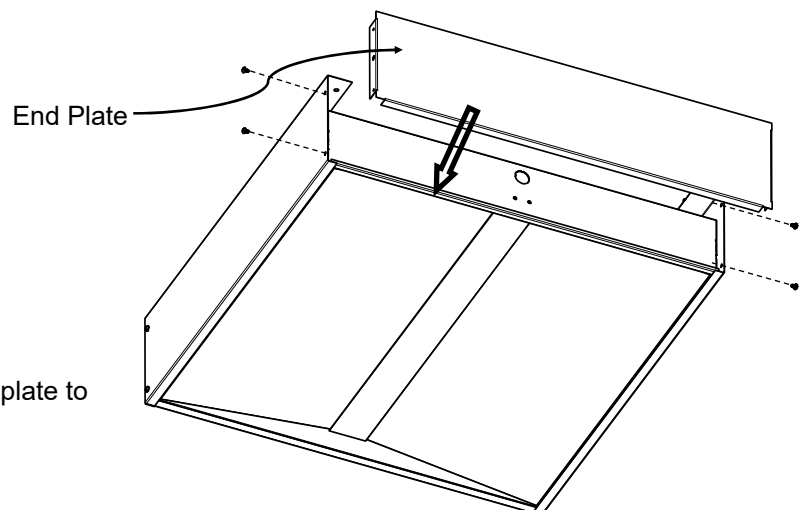

Step 4. Re-fasten the end plate to close the frame kit.